

Skill Assessment (Written Test)

Jobrole Assistant Surveyor

QP Code CON/Q0901

Total marks: 30 marks

Duration: 300 minutes

Infrastructure: Auto level and accessories, Measuring tape, Lime, Paint, nail,Mason line,Hammer

CON/N0901: Identify, select, use and store appropriate tools and instruments as per instructions

- 1** A levelling work is to be done by auto level. Select and shift instrument and accessories,consumables to site and post completion work,collect,shift and store at designated place **10**

CON/N0902:Provide support in various surveying works

- 2** Refer figure 1, measure distance between coronor points by measuring tape and intsmall hurdles/profiles at each coronor point, maintaining same level for each profile with help of auto level and connect these points by threads and mark the set building line by line **10**

Note: The auto level will be operated by surveyor, The candidate will only hold the levelling staff

CON/N9001: Work according to personal health, safety and environment protocol at construction site

- 3** Refer activities of NOS 1 and 2, demonstrate use of relevant PPEs applied to these activities. **10**

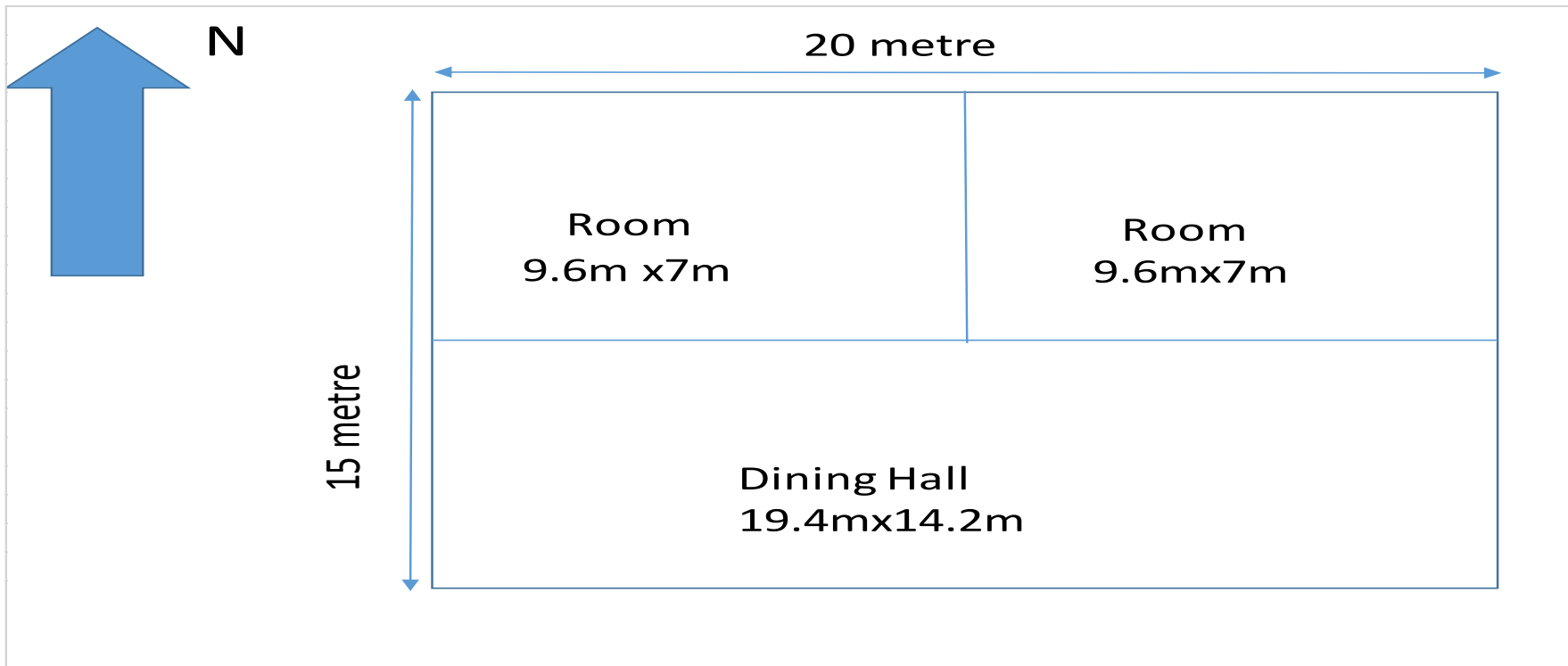

Figure 1